

GENERAL NOTES

- ALL DIMENSIONS ARE IN MILLIMETRES (mm) UNLESS OTHERWISE NOTED
- ALL LEVELS ARE IN METERS AND RELATE TO THE ORDANCE SURVEY DATUM.
- FULL DETAIL OF TUNNEL AND SERVICES CO-ORDINATION TO BE PROVIDED WITH FULL PLANNING PERMISSION.
- ALL PIPE DETAILS SHALL BE IN ACCORDANCE WITH IRISH WATER CODE OF PRACTICE FOR WATER INFRASTRUCTURE AND IRISH WATER STANDARD DETAILS.
- PIPE BEDDING SHALL COMPLY WITH WIS 4-08-02 AND IGN 4-08-01.
- PIPES SHALL NOT BE SUPPORTED ON STONES OR ROCKS, OR ANY HARD OBJECT AT ANY POINT ALONG THE TRENCH. ROCK SHALL BE EXCAVATED TO A DEPTH OF 150mm BELOW THE ACTUAL DEPTH OF THE TRENCH WITH THE VOID FILLED WITH CLAUSE 804 MATERIAL IN ACCORDANCE WITH THE NATIONAL ROADS AUTHORITY SPECIFICATION FOR ROAD WORKS. THE GRANULAR MATERIAL SHALL BE LAID ABOVE THIS VOID BACKFILL MATERIAL.
- SHOULD PIPES HAVE MINIMUM COVER OF LESS THAN 800mm, CONCRETE GRADE C8/10 SHALL BE USED AS BACKFILL MATERIAL.
- ALL WORKS OUTSIDE OF THE BOUNDARY ARE TO BE CARRIED OUT BY IRISH WATER.
- WHERE SEPARATION DISTANCE BETWEEN PIPE CROSSINGS ARE LESS THAN 300mm CONCRETE SURROUND IS TO BE PROVIDED IN ACCORDANCE WITH STD-W-08 OF IRISH WATER CODE OF PRACTICE.
- GIVEN THE PROXIMITY OF TREES, FOR TREE ROOT PROTECTION, TRENCHLESS ACTIVITIES TO BE CONSIDERED BY CONTRACTOR.
- THE DESIGN HAS ACCOUNTED FOR SITE SPECIFIC GROUND CONDITIONS, IDENTIFIED FROM THE IGSL GROUND INVESTIGATION REPORT, MAY 2022.
- BULK FLOW METER IS TO BE PROVIDED AS DETAILED IN STD-W-26A. METER IS TO BE SELECTED, SUPPLIED & FITTED BY IRISH WATER. FOR CLARITY BOUNDARY BOXES SHOWN FOR METERS INTO RESIDENTIAL BLOCKS & BULK METERS FOR THE COMMERCIAL UNITS.
- AIR VALVE & HYDRANTS COVERS, WHERE LOCATED IN GRASS AREAS, SHALL BE SURROUNDED BY A CONCRETE PLINTH, 200mm ALL ROUND & 100mm DEEP, FORMED WITH C20/25 CONCRETE, 20mm AGGREGATE SIZE, & BEDDED IN CLAUSE 804 MATERIAL. THE PLINTH SHALL INCORPORATE MILD STEEL REINFORCEMENT LINKS & SHALL HAVE A BULL-NOSE FINISH AROUND IT'S EXTERNAL PERIMETER.
- AIR VALVES SHALL BE DOUBLE ORIFICE TYPE & SHALL INCLUDE AN ISOLATING VALVE. THE ISOLATING VALVE SHALL BE EITHER A GATE VALVE CONFORMING TO IS EN 1074-2 & SHALL BE OF A BOLTLESS BONNET DESIGN, OR A BUTTERFLY VALVE TO IS EN 1074-2.
- ALL SCOUR VALVES WILL CONNECT INTO THE PROPOSED STORM NETWORK FOLLOWING APPROVAL WITH DLR COCO.

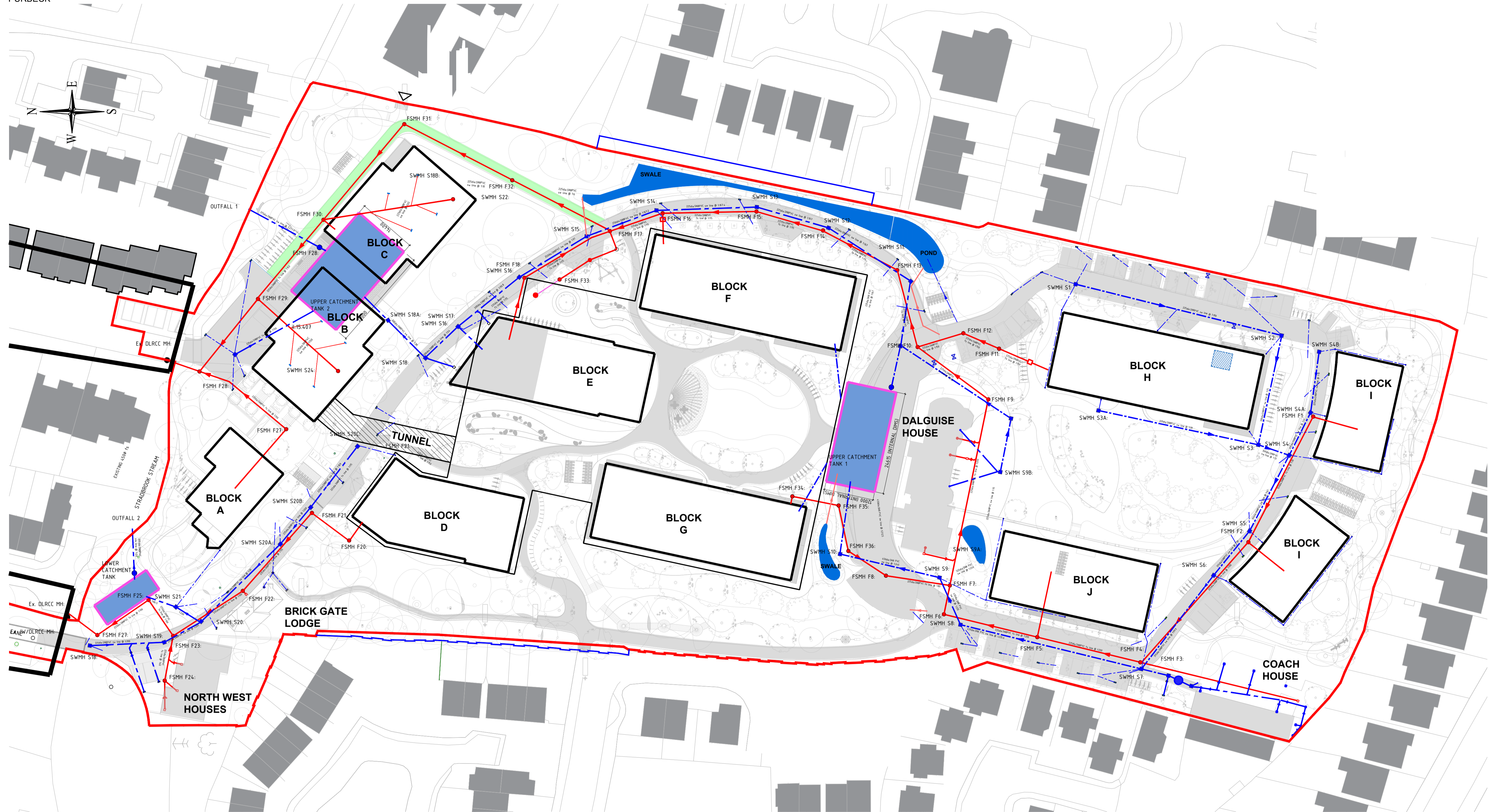

LEGEND:

- INDICATES EXTENT OF APPLICATION SITE AREA WITHIN APPLICATION
- INDICATES ADJACENT SITE IN OWNERSHIP OF APPLICANT
- - - OUTLINE OF PROPOSED BUILDINGS
- - - OUTLINE OF U/G EXCAVATION
- RISING MAIN
- GREEN/BLUE ROOF
- PAVING
- ATS-NETLON OR SIMILAR APPROVED EMERGENCY ACCESS

Rev	Date	Description	By	Chk	App
03	07/07/23	ISSUE FOR INFORMATION	SG	RT	AG
02	23/06/23	ISSUE FOR INFORMATION	SG	RT	AG
01	02/06/23	ISSUE FOR INFORMATION	SG	RT	AG
00	28/09/22	ISSUE FOR INFORMATION	LT	RT	AG

**BYRNE LOOBY**  
WWW.BYRNELOOBY.COM  
IRELAND | UK | UAE | BAHRAIN | KSA

CLIENT  
GEDV MONKSTOWN OWNER LIMITED

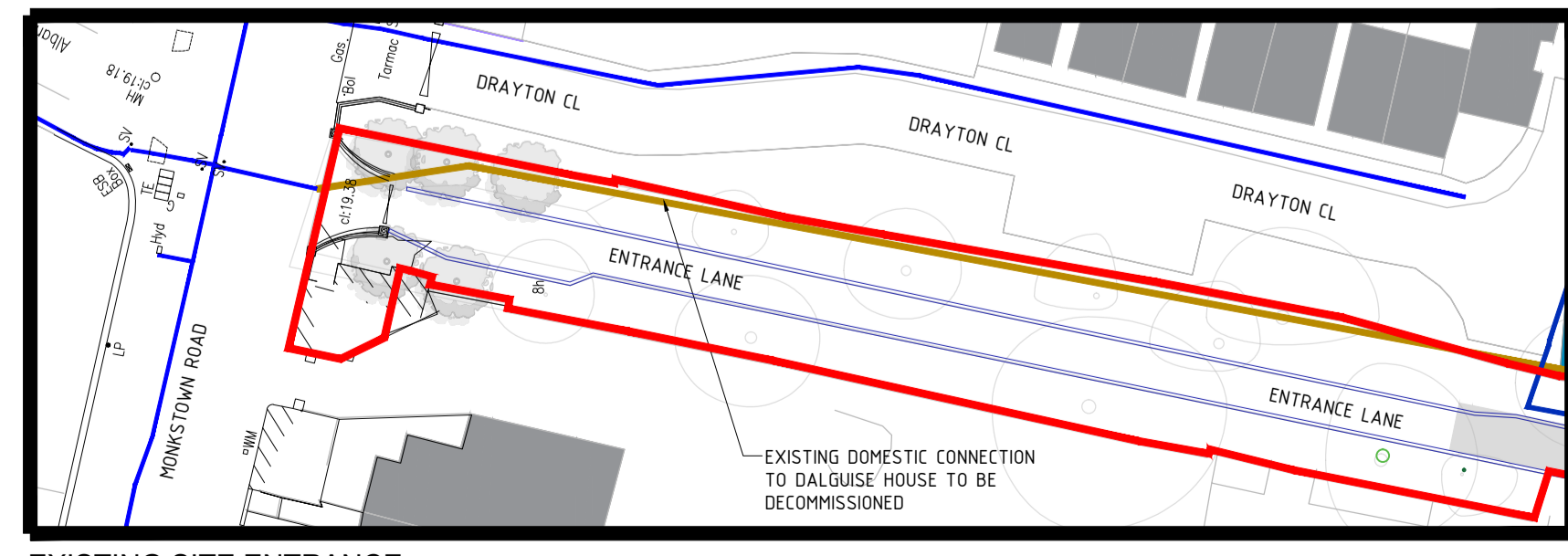

PROPOSED UTILITIES PLAN  
SCALE: 1:500

PROPOSED FOUL UTILITIES LEGEND

EXISTING FOUL MANHOLE  
EXISTING GRAVITY MAIN (COMBINED)  
EXISTING GRAVITY MAIN (FOUL)  
NEW FOUL MANHOLE  
NEW FOUL PIPE

Existing FS MH  
PIPE DESCRIPTION  
PIPE DESCRIPTION  
FS MH  
PIPE DESCRIPTION

PROPOSED STORM UTILITIES LEGEND

EXISTING SURFACE WATER MANHOLE  
EXISTING SURFACE WATER PIPE  
NEW SURFACE WATER MANHOLE  
NEW SURFACE WATER PIPE  
SURFACE ACCESS JUNCTION  
RAINWATER PIPE  
ROAD GULLY  
HYDRO-BRAKE MANHOLE  
ACO DRAIN

Existing SW MH  
PIPE DESCRIPTION  
SW MH  
PIPE DESCRIPTION  
AJ  
RWP  
RG

PROJECT  
RESIDENTIAL DEVELOPMENT ON LANDS OF DALGUISE HOUSE

DRAWING TITLE  
PROPOSED UTILITIES PLAN  
STORM WATER & FOUL LAYOUT COMBINED

STATUS  
FOR INFORMATION

Date	28/09/22	Scale	AS SHOWN	Drawn	LT	Chk	RT	App	AG
Project No.	W3683	Drg. No.	W3683-DR-1039	Rev.					